

Owner's Manual: Universal Fire Extinguisher Seat Mount (Models SM01BR and SM01BK)

Thank you for your purchase! This versatile mount provides a secure platform to install a fire extinguisher in a vehicle while avoiding the need to drill mounting holes. It can attach to existing mounting holes from 8 7/8" to 19 1/4" apart, and is designed to work with a wide variety of automobile seats.

Illustrated parts list

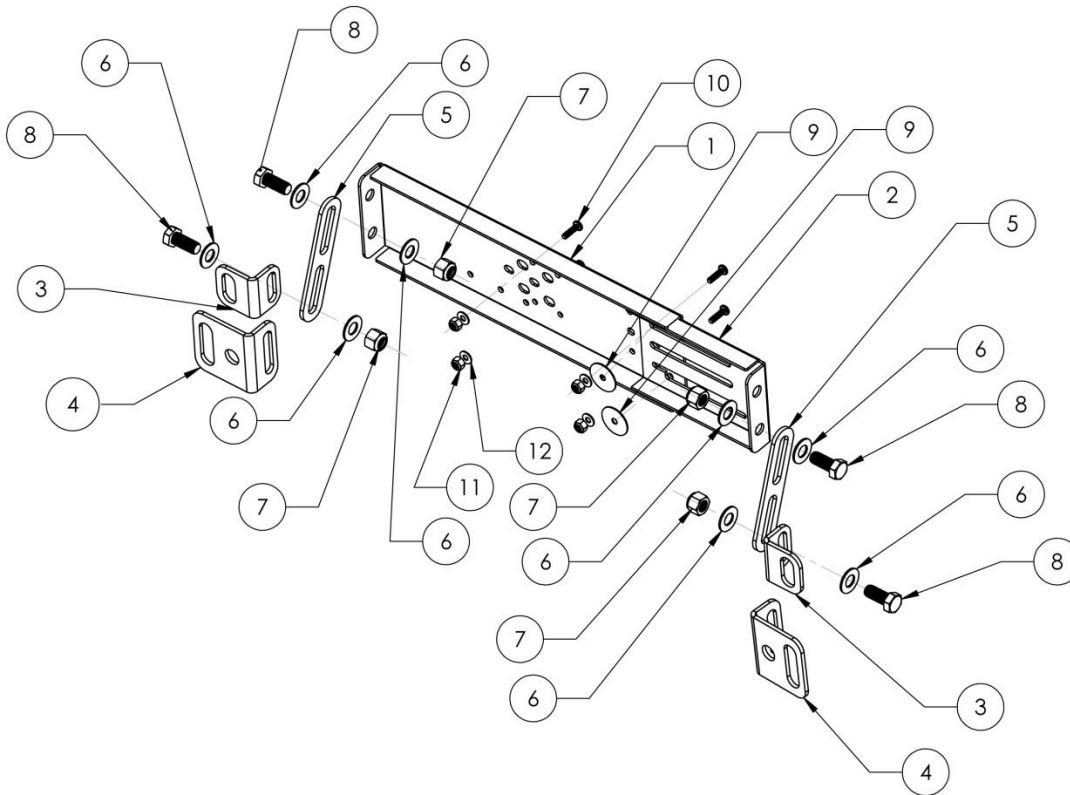

Item #	Description	Qty.
1	MAIN SUPPORT BAR	1
2	SUPPORT BAR ADJUSTER	1
3	SMALL MOUNTING TAB	2
4	LARGE MOUNTING TAB	2
5	EXTENSION ARM	2
6	MEDIUM WASHER	8
7	LARGE LOCK NUT	4
8	SOCKET HEAD CAP SCREW	4
9	LARGE WASHER	2
10	PHILLIPS SCREW	4
11	SMALL LOCK NUT	4
12	SMALL WASHER	3

DISCLAIMER: A professional should install and/or inspect installation of this product. In no event may H3R Performance be held responsible for unsafe installation, inspection, testing, operation, and maintenance practices of users employing this product or for any property damage or personal injuries arising out of the use or handling of this product by anyone other than trained users having appropriate technical and mechanical expertise.

WARNING: Lock nuts are prone to galling/seizing. When test fitting apply lubricant to the screw threads and slowly rotate the lock nuts to avoid galling/seizing.

Assembly instructions

1. Insert SUPPORT BAR ADJUSTER (#2) into the MAIN SUPPORT BAR (#1).
2. Attach the fire extinguisher bracket using the LARGE (#9) and SMALL (#12) WASHERS, the PHILLIPS SCREWS (#10), and the SMALL LOCK NUTS (#11) and hand tighten. Use the LARGE WASHERS where the SUPPORT BAR ADJUSTER and MAIN SUPPORT BAR overlap.
3. Attach the EXTENSION ARMS to the ends of the MAIN SUPPORT BAR and SUPPORT BAR ADJUSTER and hand tighten using hardware items #6, #7 and #8.
4. Attach MOUNTING TABS (#3 or #4 as needed for best fit) to EXTENSION ARMS (#5) and hand tighten with hardware items #6, #7 and #8.
5. Test fit loosely assembled mount in vehicle and adjust fit. The mount can accommodate a range of mounting locations including the seat rail and seat slider. (Note: Mounting to the seat slider, if possible, provides greatest range of movement.)
6. Once a location has been selected, attach the fire extinguisher to the bracket, ensuring that the bracket straps (or pull pin) can open freely and that the extinguisher can be easily deployed.
7. Securely tighten all Seat Mount fasteners and then torque vehicle attachment points to the manufacturer's specification.

Limited Warranty

H3R Performance, Inc. ("H3R") warrants this product for a period of one (1) year from the date of purchase to be free from defects in material and workmanship. During the warranty period any such defects will be repaired or the defective mount replaced. This warranty does not cover defects resulting from modification, alteration, misuse, exposure to corrosive conditions or improper installation or maintenance. ALL IMPLIED WARRANTIES, INCLUDING, BUT NOT LIMITED TO, WARRANTIES OF FITNESS FOR PURPOSE AND MERCHANTABILITY, ARE LIMITED TO THE TIME PERIODS STATED ABOVE. IN NO EVENT SHALL H3R BE LIABLE TO INCIDENTAL OR CONSEQUENTIAL DAMAGES. H3R neither assumes nor authorizes any representative or other person to assume for it, any obligation or liability other than as expressly set forth herein. This warranty gives you specific legal rights and you may have other rights which vary from state to state. To obtain performance of the obligation of this warranty, write to H3R Performance, Inc., 103 H Street, Petaluma, CA 94952, or email H3Rinfo@H3RPerformance.com for instructions.